

1		2		1	
REVISION HISTORY					
ZONE	REV	DESCRIPTION	DATE	DWN	CHK
	A	RELEASED PER ECN 1037999			

GDHF-DIM-624H
DATE-10/01/07

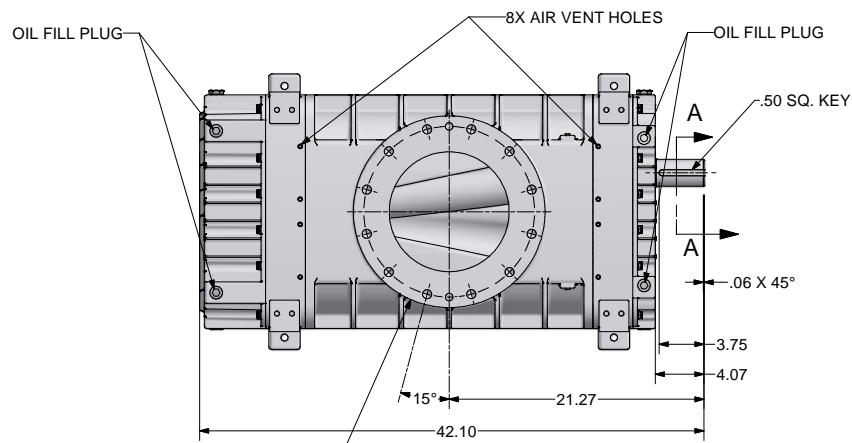

10" 150# FLANGE
12X 7/8-9 UNC-3B ∇ 1.26
EQ. SPACED \varnothing 14.25 B.C.
INLET

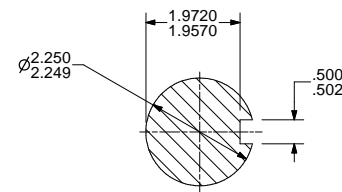

SECTION A-A
SCALE 1 : 1



C.Emery Nelson, Inc.

INDUSTRIAL AND POWER PLANT EQUIPMENT

7631 Commerce Street, Hamel, MN 55340

Ph: 763/ 420-3844 Fax: 763/420-2542

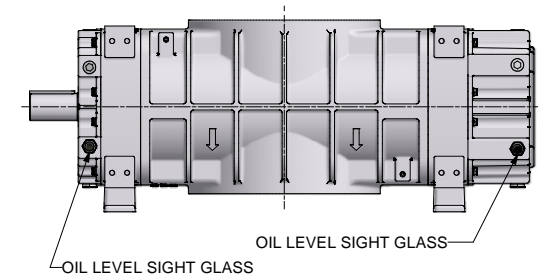
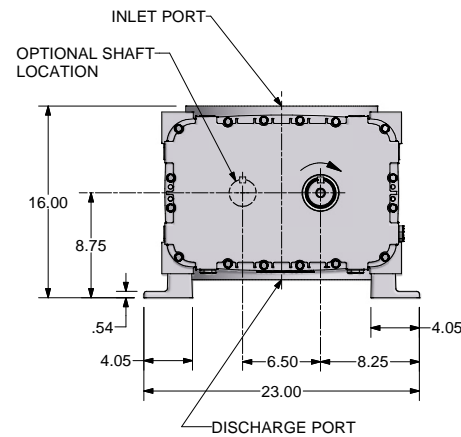
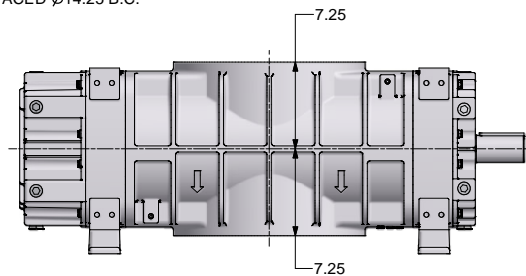

10" 150# FLANGE
12X 7/8-9 UNC-3B ∇ 1.26
EQ. SPACED \varnothing 14.25 B.C.
OUTLET

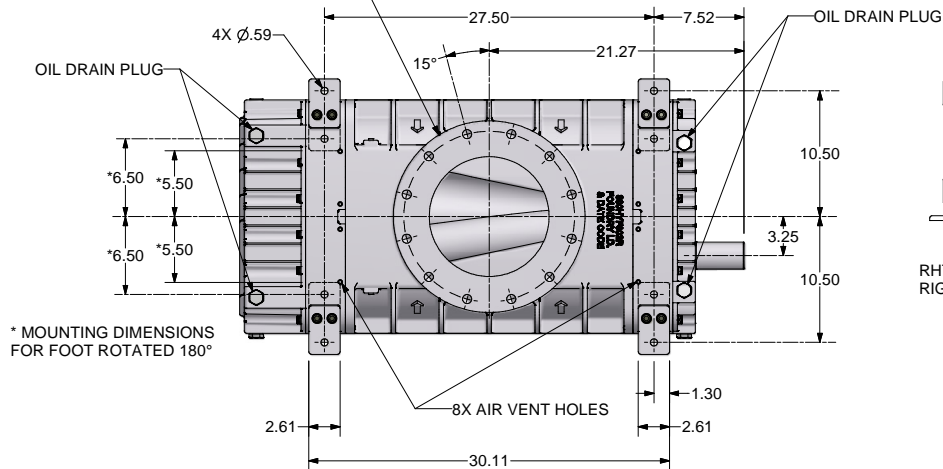

* MOUNTING DIMENSIONS
FOR FOOT ROTATED 180°

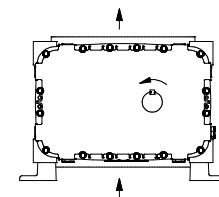

RHTD CCW ROTATION
RIGHT HAND TOP DISCHARGE

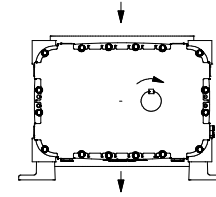

RHBD CW ROTATION (SHOWN)
RIGHT HAND BOTTOM DISCHARGE

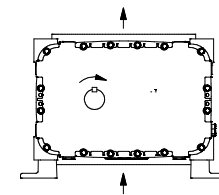

LHTD CW ROTATION
LEFT HAND TOP DISCHARGE

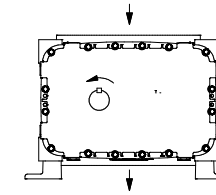

LHBD CCW ROTATION
LEFT HAND BOTTOM DISCHARGE

FINISH OF CHAMFERS AND FILLETS TO CONFORM TO
ROUGHEST ADJACENT AREA.
SURFACE ROUGHNESS MAXIMUM PER ASME B46.1.
FULL THREAD DEPTHS ARE MINIMUM.

UNLESS OTHERWISE SPECIFIED
DIMENSIONS ARE IN INCHES
TOL. ON DECIMALS: X = $\pm .05$
TOL. ON DECIMALS: XX = $\pm .02$
TOL. ON DECIMALS: XXX = $\pm .01$ AS SPECIFIED
TOL. ON ANGLES: $\pm 0^{\circ} 30'$

THIRD ANGLE PROJECTION 

CONFIDENTIAL - THE INFORMATION CONTAINED IN THIS DOCUMENT IS THE PROPERTY OF GARDNER DENVER, INC. IT IS NOT FOR PUBLIC DISCLOSURE. POSSESSION OF THE INFORMATION DOES NOT CONVEY ANY RIGHT TO LOAN, SELL OR DISCLOSE THE INFORMATION. UNAUTHORIZED REPRODUCTION OR USE OF THE INFORMATION IS PROHIBITED. THIS DOCUMENT IS TO BE RETURNED TO GARDNER DENVER, INC. UPON THE COMPLETION OF THE PURPOSE FOR WHICH IT IS LOANED OR UPON REQUEST.

DIMENSIONING AND TOLERANCING PER ASME Y14.5M-1994
THREADS PER ASME B1.1 GAGING SYSTEM 21 U.O.S. - ANSI B1.20.1 & B1.20.3

Gardner	HEAT TREATMENT	ENG. REF:

ED	Denver	TITLE	OUTLINE-BARE UNIT
----	---------------	-------	-------------------

Gardner Denver Inc. Quincy, IL.	OUTLINE-BARE UNIT HELIFLOW 624 HORIZONTAL			
	1000	1000	1000	1000

DWN BY RRB 10/8/2007	E	WSC	305HYF800	A
CK'D BY RNS 10/8/2007	A/A		INSET 4 06 1	