



# C. Emery Nelson, Inc.

INDUSTRIAL AND POWER PLANT EQUIPMENT

7631 Commerce Street, Hamel, MN 55340  
 Ph: 763/ 420-3844 Fax: 763/420-2542

ZONE		REV	DESCRIPTION	DATE	DWN	CHK
		A	RELEASED PER ECN 1040966			

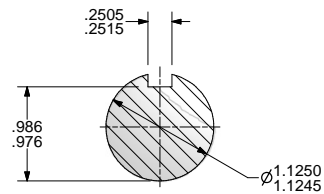
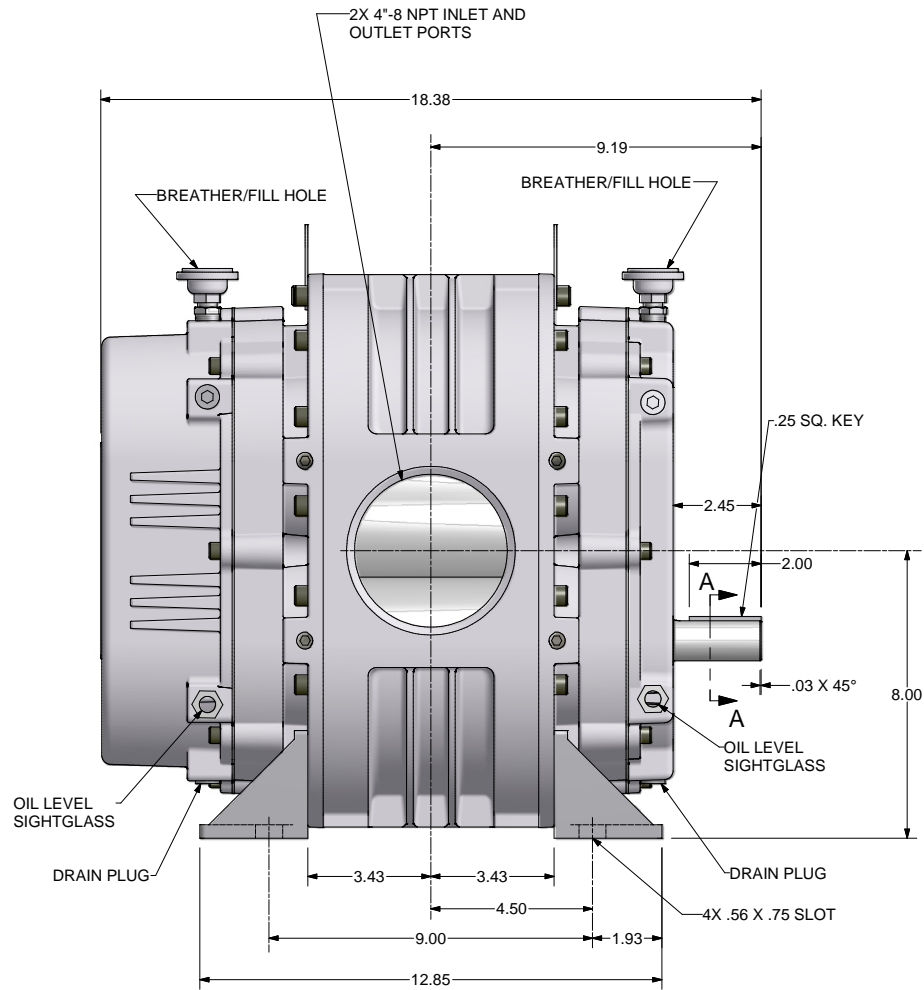

SECTION A-A  
 SCALE 2 : 1

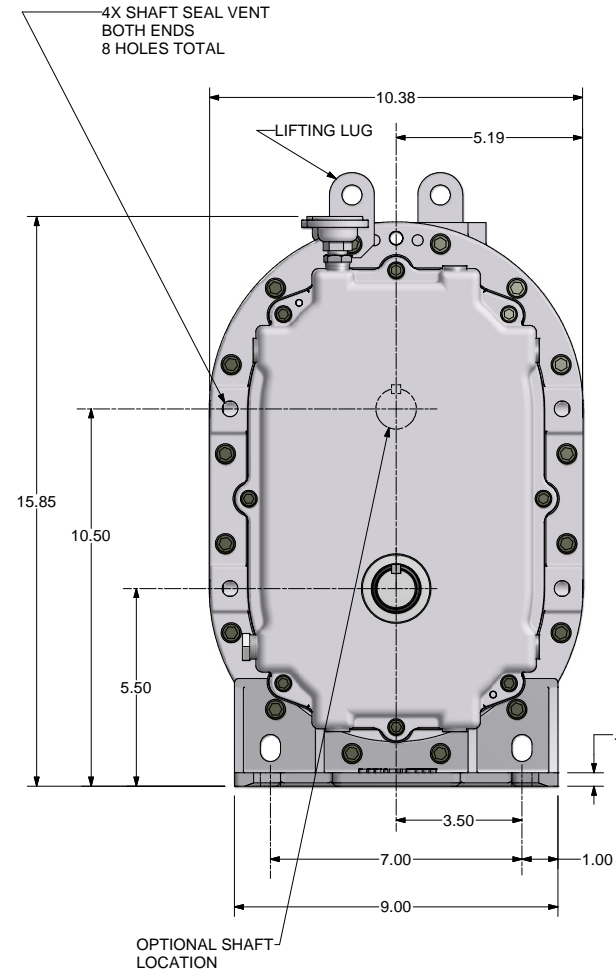

ALL ROTATIONS AND PORT LOCATIONS WHEN FACING SHAFT END

CONSTRUCTION	ROTATION	DISCHARGE PORT
VERTICAL BOTTOM	CLOCK WISE (CW) COUNTERCLOCKWISE (CCW)	LEFT SIDE RIGHT SIDE
VERTICAL TOP	CLOCKWISE (CW) COUNTERCLOCKWISE (CCW)	RIGHT SIDE LEFT SIDE

UNLESS OTHERWISE SPECIFIED DIMENSIONS ARE IN INCHES  
 TOL. ON DECIMALS: .X = ± .05  
 TOL. ON DECIMALS: .XX = ± .005  
 TOL. ON DECIMALS: .XXX = ± .001  
 TOL. ON ANGLES: ± 0.30°

FINISH OF CHAMFERS AND FILLETS TO CONFORM TO ROUGHNESS MAXIMUM PER ASME B46.1. FILL THREAD DEPTHS ARE MAXIMUM.

CONFIDENTIAL: THE INFORMATION CONTAINED IN THIS DOCUMENT IS THE PROPERTY OF GARDNER DENVER, INC. IT IS NOT TO BE DISCLOSED, REPRODUCED, COPIED, OR TRANSMITTED IN ANY FORM OR BY ANY MEANS, ELECTRONIC OR MECHANICAL, INCLUDING PHOTOCOPYING, RECORDING, OR BY ANY INFORMATION STORAGE AND RETRIEVAL SYSTEM. UNAUTHORIZED REPRODUCTION OR USE OF THE INFORMATION IS PROHIBITED. THIS DOCUMENT IS TO BE RETURNED TO GARDNER DENVER, INC. UPON THE COMPLETION OF THE PURPOSE FOR WHICH IT IS LOANED OR UPON REQUEST.

DIMENSIONING AND TOLERANCING PER ASME Y14.5M-1994  
 THREADS PER ASME B1.1 (CLASSIC SYSTEM) 21 UN-2B AND B1.203 1.8 81.203

**Gardner Denver Inc.** HEAT TREATMENT ENG. REF. A  
**Denver** TITLE OUTLINE-BARE UNIT  
 Gardner Denver Inc. SMVR LEGEND DSL  
 Quincy, IL  
 DWN BY: RNS 5/15/2008 E WSC 312GAE800  
 CTD BY: RNS 5/15/2008