



C. Emery Nelson, Inc.

INDUSTRIAL AND POWER PLANT EQUIPMENT

7631 Commerce Street, Hamel, MN 55340
 Ph: 763/420-3844 Fax: 763/420-2542

ZONE		REVISION HISTORY		DATE	DWN	CHK
A		RELEASED PER ECN 1040966				

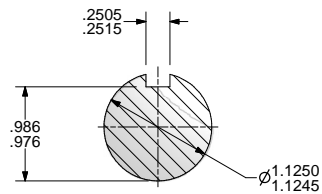
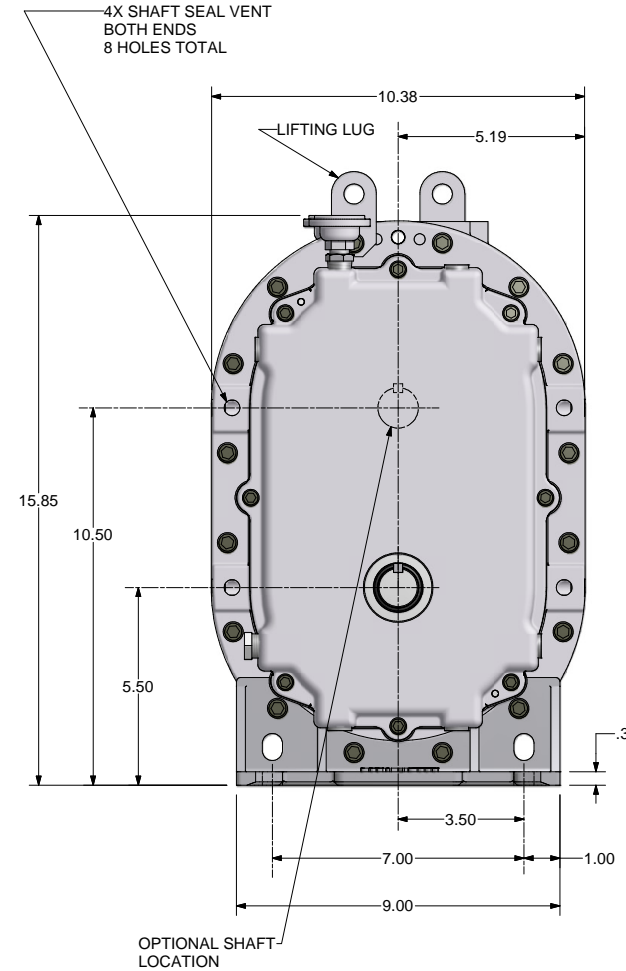
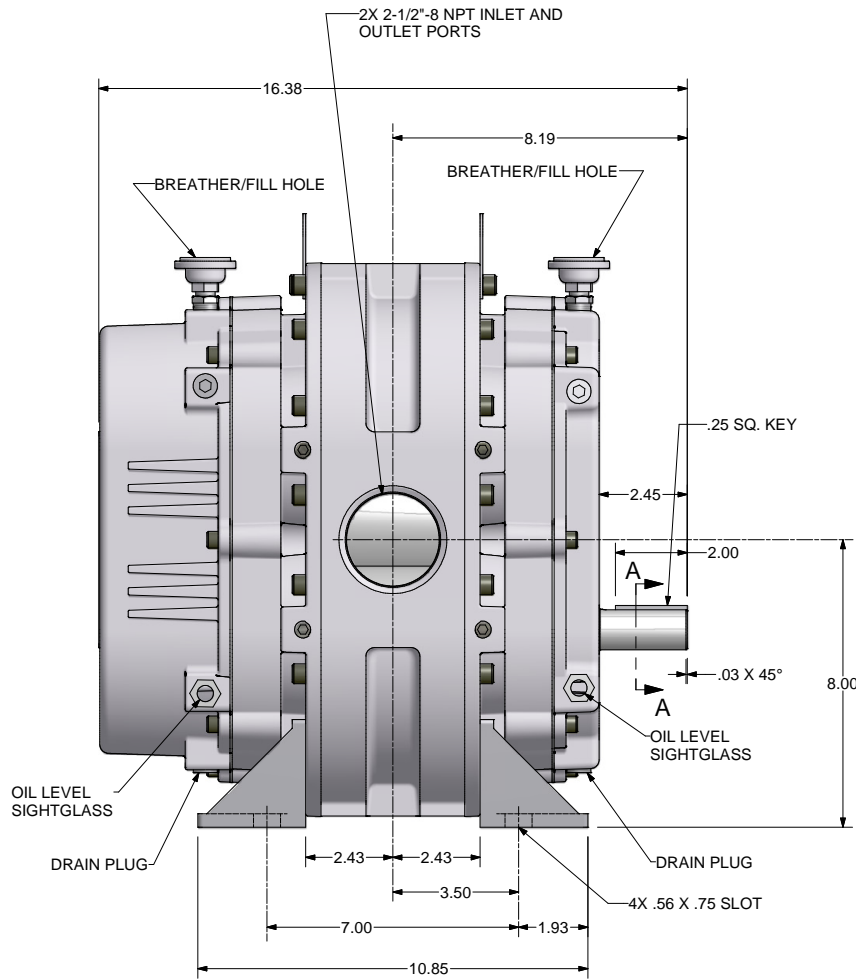

SECTION A-A
 SCALE 2 : 1

ALL ROTATIONS AND PORT LOCATIONS WHEN FACING SHAFT END

CONSTRUCTION	ROTATION	DISCHARGE PORT
VERTICAL BOTTOM	CLOCK WISE (CW) COUNTERCLOCKWISE (CCW)	LEFT SIDE RIGHT SIDE
VERTICAL TOP	CLOCKWISE (CW) COUNTERCLOCKWISE (CCW)	RIGHT SIDE LEFT SIDE

UNLESS OTHERWISE SPECIFIED DIMENSIONS ARE IN INCHES
 TOL. ON DECIMALS: .X = ± .05
 TOL. ON DECIMALS: .XX = ± .005
 TOL. ON DECIMALS: .XXX = ± .001 AS SPECIFIED
 TOL. ON ANGLES: ± 0.30°

FINISH OF CHAMFERS AND FILLETS TO CONFORM TO ROUGHENED SURFACE AREA.
 SURFACE ROUGHNESS MAXIMUM PER ASME B46.1.
 FILL THREAD DEPTHS ARE MAXIMUM.

CONFIDENTIAL: THE INFORMATION CONTAINED IN THIS DOCUMENT IS THE PROPERTY OF GARDNER DENVER, INC. IT IS NOT FOR PUBLIC DISCLOSURE. POSSESSION OF THE INFORMATION DOES NOT CONFER ANY RIGHT TO LOAN, REPRODUCE, OR DISCLOSE THE INFORMATION. UNAUTHORIZED REPRODUCTION OR USE OF THE INFORMATION IS PROHIBITED. THIS DOCUMENT IS TO BE RETURNED TO GARDNER DENVER, INC. UPON THE COMPLETION OF THE PURPOSE FOR WHICH IT IS LOANED OR UPON REQUEST.

DIMENSIONING AND TOLERANCING PER ASME Y14.5M-1994
 THREADS PER ASME B1.1 (SAE) SYSTEM 21 (UN) UNF-2A
 ANSI B1.20.1 & B1.20.3

HEAT TREATMENT: ENG. REF. A
 TITLE: OUTLINE-BARE UNIT
 SHVR LEGEND DSL
 GARDNER DENVER INC. QUINCY, IL
 DWN BY: RNS 5/20/2008
 E WSC 317GAE800
 CTD BY: RNS 5/20/2008